



LBC 3011/x1 Panel Loudspeakers



- ▶ **High-quality speech and music reproduction**
- ▶ **Two-way system**
- ▶ **Simple power setting**
- ▶ **Flush-mounting in walls, ceilings, or furniture**
- ▶ **Surface-mounting and flush mounting boxes**
- ▶ **Available with or without integral volume control**
- ▶ **Compliance with international installation and safety regulations**
- ▶ **BS 5839-8 compliance**

The Bosch panel loudspeakers and matching mounting boxes are ideal for built-in sound installations in shops, department stores, schools, offices, hotels and restaurants. They are manufactured and finished to the same exacting standards as all Bosch public address systems and components, guaranteeing high quality, and compatibility throughout the range.

The loudspeaker has built-in protection to ensure that, in the event of a fire, damage to the loudspeaker does not result in failure of the circuit to which it is connected. In this way, system integrity is maintained, ensuring loudspeakers in other areas can still be used to inform people of the situation. The loudspeaker has a ceramic terminal block, thermal fuse, and heat-resistant, high-temperature wiring.

Functions

The 9 W (max. power) panel is equipped with a woofer and tweeter, enabling excellent quality speech and music reproduction. They are available with or without an integral volume control (LBC 3011/51 and LBC 3011/41, respectively). Nominal output power can be preset to full, half, or quarter-power radiation (in 3 dB steps) by connecting the 100 V line to the appropriate primary taps on the matching transformer via a 2-pole screw connector.

The off-white (RAL 9010) panels are injection-molded from self-extinguishing, high-impact ABS material (according to UL 94V0). They are finished with an attractive perforated metal grill.

The panel loudspeakers flush-mount into rectangular cutouts in cavity walls, ceilings, furniture or custom-made cabinets. The panels have provision on the rear side for mounting an optional line/loudspeaker supervision board.

Certifications and Approvals

Voice alarm loudspeakers are specifically designed for use in buildings, where performance of systems for verbal evacuation announcements is governed by regulations. The LBC 3011/x1 is designed for use in voice alarm systems and is compliant with British Standard BS 5839-8.

Safety	acc. to EN 60065
EVAC	acc. to BS 5839-8
Self-extinguishing	acc. to UL 94 V0

Installation/Configuration Notes

LBC 3011/41

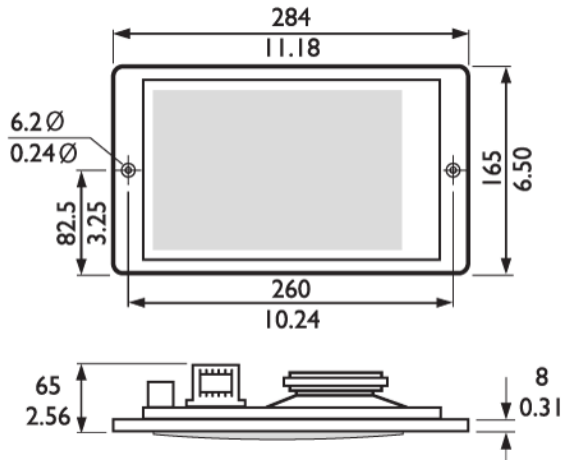

Dimensions in mm (in)

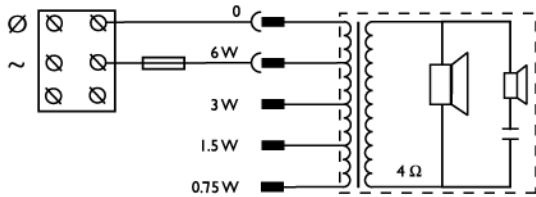

Circuit diagram

LBC 3011/51

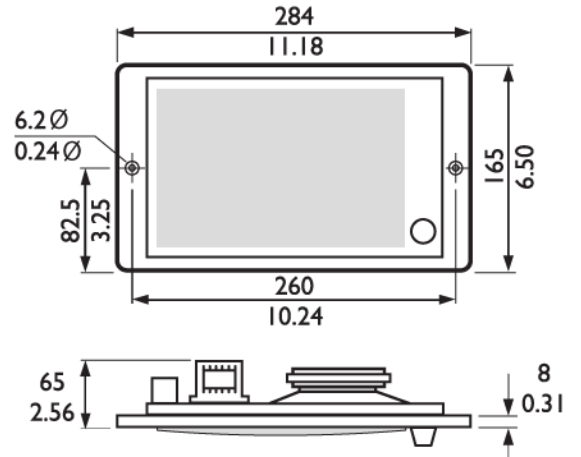

Dimensions in mm (inch)

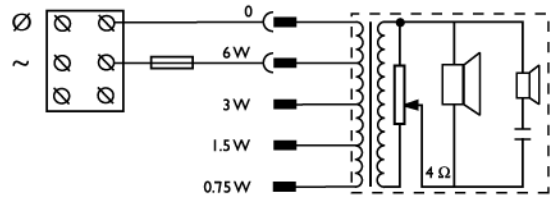

Circuit diagram

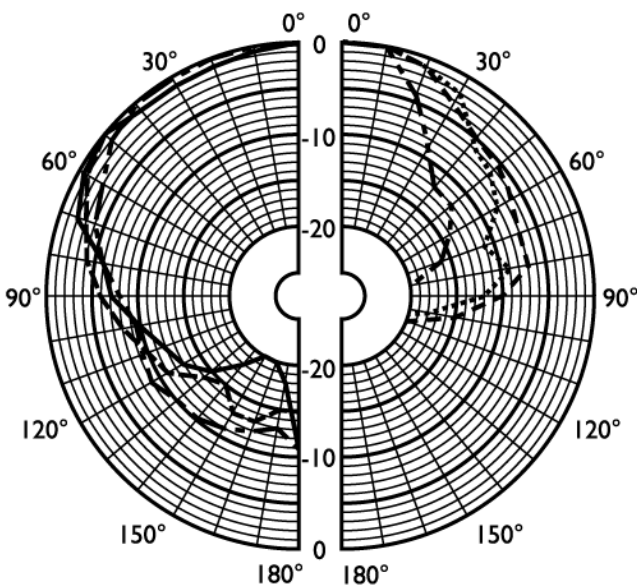

- 250 Hz
- 500 Hz
- 1000 Hz
- 2000 Hz
- 4000 Hz
- 8000 Hz

Polar diagram horizontal (measured with pink noise)

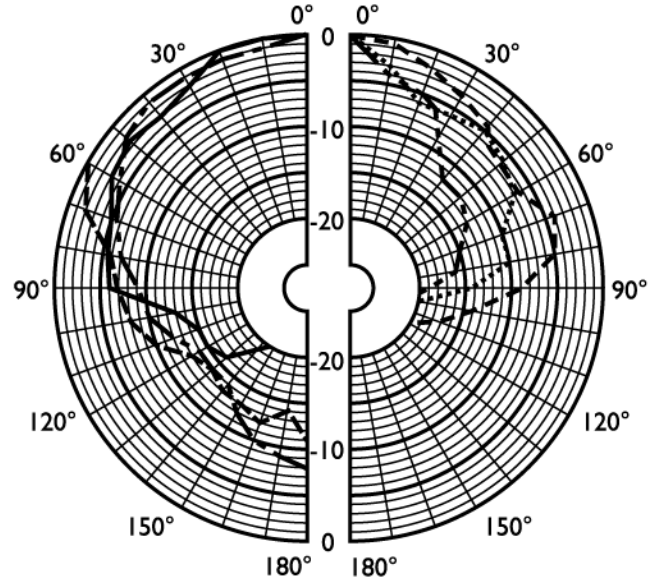

- 250 Hz
- 500 Hz
- 1000 Hz
- 2000 Hz
- 4000 Hz
- 8000 Hz

Polar diagram vertical (measured with pink noise)

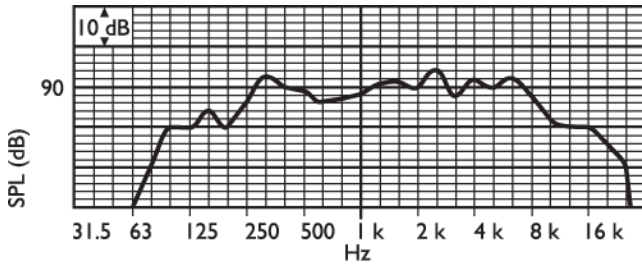

Frequency response

	125 Hz	250 Hz	500 Hz	1 kHz	2 kHz	4 kHz	8 kHz
SPL 1.1	85	90	88	88	92	90	89
SPL max.	93	98	96	96	100	98	97
Q-factor	5.1	3.9	2.1	3.7	7.4	9.1	31.6
Efficiency	0.08	0.32	0.37	0.21	0.27	0.14	0.03
H. angle	180	180	160	160	115	85	45
V. angle	180	180	160	180	85	100	50

Acoustical performance specified per octave

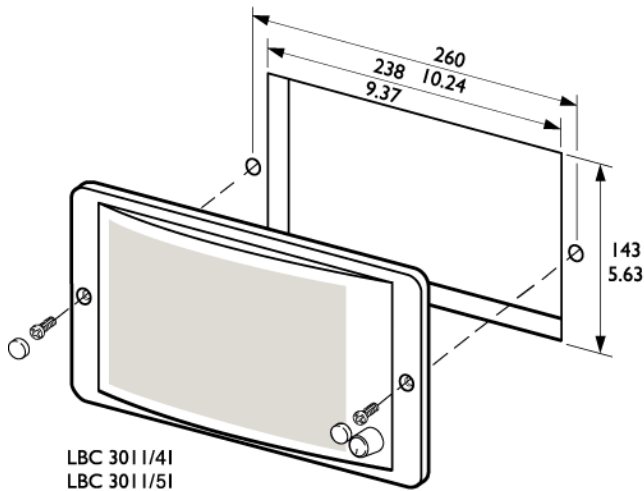

LBC 3011/41
LBC 3011/51

Recessed mounting in walls and ceilings. Dimensions in mm (inch)

Two mounting boxes are available for surface mounting onto hard surfaces or flush-mounting into non-cavity walls. The LBC 3012/01 accommodates the panel loudspeaker for a self-contained unit for surface mounting.

LBC 3012/01 Mounting box for surface mounting

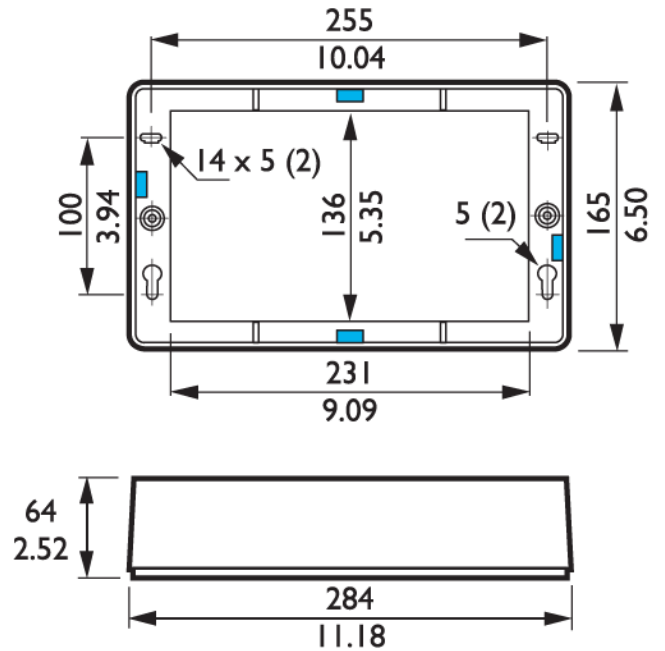

Dimensions in mm (in) with knockout boxes

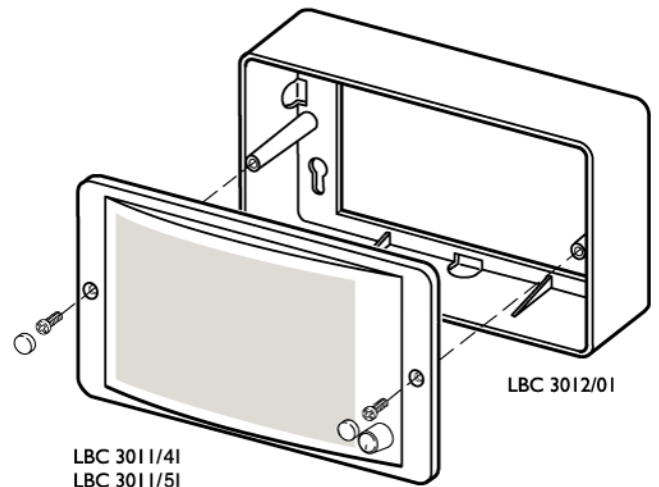

LBC 3011/41
LBC 3011/51

Surface mounting

LBC 3013/01 Mounting box for flush mounting

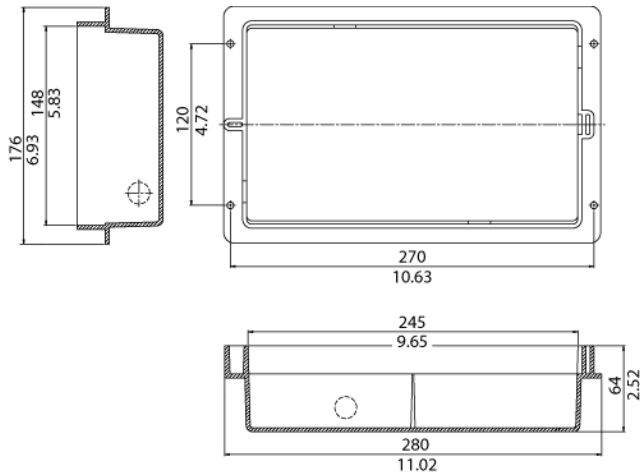

Dimensions in mm (in)

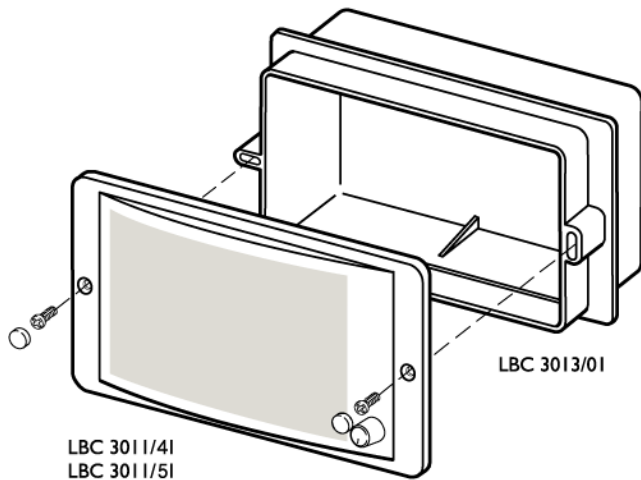

Flush mounting

Technical Specifications

Electrical* LBC 3011/41 and LBC 3011/51

Max power	9 W
Rated power (PHC)	6 / 3 / 1.5 / 0.75 W
Sound pressure level at 6 W / 1 W (1 kHz, 1 m)	96 dB / 88 dB (SPL)
Effective frequency range (-10 dB)	75 Hz to 18 kHz
Opening angle horizontal	1 kHz / 4 kHz (-6 dB) 160° / 85°
vertical	180° / 100°
Rated voltage	100 V

Rated impedance	1667 ohm
Connector	2-pole screw

* Technical performance data acc. to IEC 60268-5

Mechanical

Dimensions (H x W x D)	165 x 284 x 59.5 mm (6.49 x 11.18 x 2.34 inch)
Mounting cut-out (H x W)	143 x 238 mm (5.63 x 9.37 inch)
Weight	1.2 kg (2.64 lb)
Color	White (RAL 9010)
Speaker size	2" / 4"
Magnet weight	48 g / 150 g (1.7 oz / 5.3 oz)

Mechanical LBC 3012/01

Dimensions (H x W x D)	165 x 284 x 64 mm (6.49 x 11.18 x 2.52 inch)
Weight	238 g (8.40 oz)
Color	White (RAL 9010)

Mechanical LBC 3013/01

Dimensions (H x W x D)	176 x 280 x 64 mm (6.49 x 11.18 x 2.52 inch)
Weight	307 g (10.83 oz)
Color	White (RAL 9010)

Environmental

Operating temperature	-25 °C to +55 °C (-13 °F to +131 °F)
Storage temperature	-40 °C to +70 °C (-40 °F to +158 °F)
Relative humidity	<95%

Ordering Information

LBC 3011/41 Panel Loudspeaker without Volume Control

LBC 3011/51 Panel Loudspeaker with Volume Control

Accessories

LBC 3012/01 Surface Mounting Box

LBC 3013/01 Flush Mounting Box

Europe, Middle East, Africa:
 Bosch Security Systems B.V.
 P.O. Box 80002
 5600 JB Eindhoven, The Netherlands
 Phone: + 31 40 2577 284
 Fax: +31 40 2577 330
 emea.securitysystems@bosch.com
 www.boschsecurity.com

Americas:
 Bosch Security Systems, Inc.
 130 Perinton Parkway
 Fairport, New York, 14450, USA
 Phone: +1 800 289 0096
 Fax: +1 585 223 9180
 security.sales@us.bosch.com
 www.boschsecurity.us

Asia-Pacific:
 Bosch Security Systems Pte Ltd
 38C Jalan Pemimpin
 Singapore 577180
 Phone: +65 6319 3450
 Fax: +65 6319 3499
 apr.securitysystems@bosch.com
 www.boschsecurity.com

Represented by